

SMD Shielded Power Inductors

GSLQ201610 / GSLQ252010 / GSLQ252012

GSLQ303010 / GSLQ303012 / GSLQ303015

GSLQ404010 / GSLQ404012 / GSLQ404018

Features (特長)

- High frequency (高頻)
- Highest possible SRF as well as excellent Q values (高共振頻率及高品質因數)
- The constitutive property is good and easy to operate (結構性佳、使用方便)

Applications (用途)

- Pager, Cordless phone & High Frequency Communication Products (呼叫器、行動電話及高頻通訊類產品)
- Intercom, CATV (對講機、CATV)

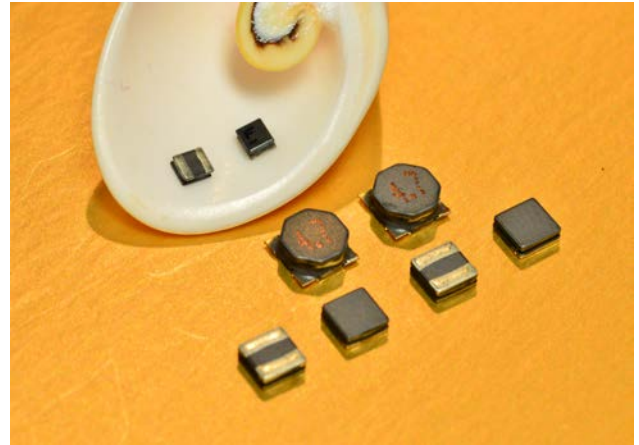

Product Identification (產品識別)

GSLQ201610 - (Ex. GSLQ201610-1R0N)

1 2 3

1. SMT Shielded Power Inductors (閉磁式功率電感) (GSLQ201610~GSLQ404018)
2. Inductance (電感值)
3. Tolerance (誤差值) (參照表 M 20%, N 30%)



Configurations & Dimensions (結構圖及規格尺寸)

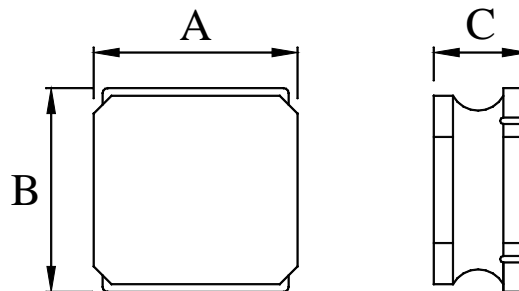

Unit In mm

Item (型式)	A ±0.2	B ±0.2	C (max)
GSLQ201610	2.0	1.6	1.0
GSLQ252010	2.5	2.0	1.0
GSLQ252012	2.5	2.0	1.2
GSLQ303010	3.0	3.0	1.0
GSLQ303012	3.0	3.0	1.2
GSLQ303015	3.0	3.0	1.5
GSLQ404010	4.0	4.0	1.0
GSLQ404012	4.0	4.0	1.2
GSLQ404018	4.0	4.0	1.8