

# Radial Choke Inductors GSRC / GSRCU

## Features (特長)

- Open Magnetic circuit construction  
(開磁路構造設計)
- Low cost and high reliability  
(低成本及高可靠性)

## Applications (用途)

- Notebook, Inkjet printer, Copying machine, Display monitor, Cellular phone, ADSL modem, Gaming machine, Color TV, Video tape recorder, Video camera, Microwave oven, Lighting and Car electronics.  
(筆記型電腦、噴墨印表機、影印機、顯示監視器、手機、寬頻數據機、遊戲機、彩色電視、錄放影機、攝影機、微波爐、照明設備、汽車電子產品)



## Product Identification (產品識別)

GSRC    0406 -       (Ex. GSRC0406-1R0M)

1      2      3      4      5

1. Radial Choke Inductors (抗流線圈) (GSRC)
2. Form (型式)  
U → UL TUBE (UL 套管)
3. Size (尺寸) (0406, 0608, 0810, 0912, 1012, 1016)
4. Inductance (電感值)
5. Tolerance (誤差值) (參照表 K 10%, L 15%, M 20%, N 30%, Y min)

# Radial Choke Inductors GSRC / GSRCU

Configurations & Dimensions (結構圖及規格尺寸)

## GSRC

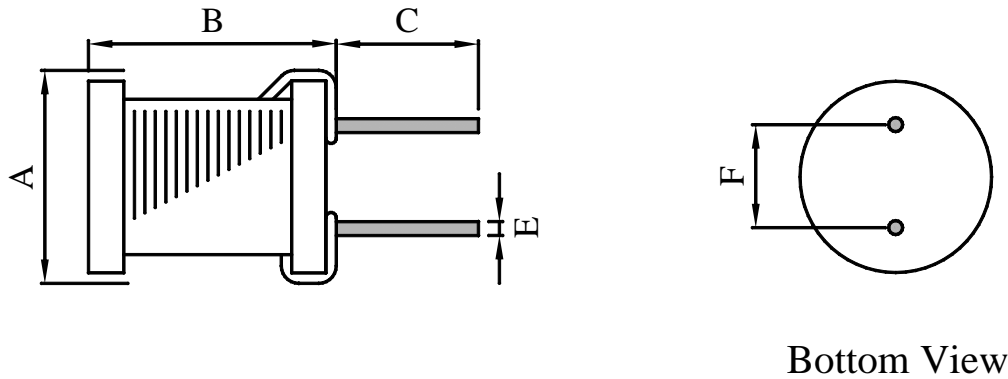

## GSRCU

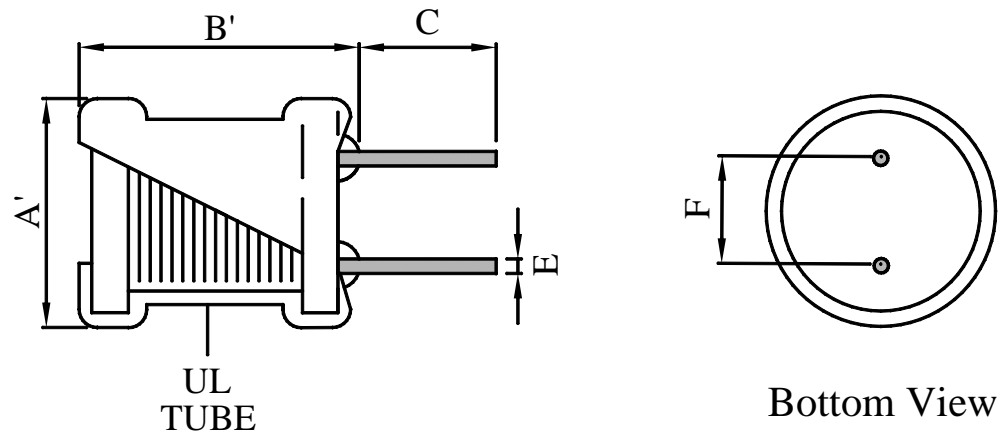

Unit In mm

Type (型式)	∅A (max)	∅A' (max)	B (max)	B' (max)	C ± 1.5	∅E ± 0.05	F ± 0.5
GSRC/U 0406	5.5	6.0	9.0	10.0	15.0	0.50	2.0
GSRC/U 0608	7.5	8.0	11.0	11.5	15.0	0.65	3.0
GSRC/U 0810 (不含 0.6 φ 以下)	9.5	10.0	13.5	14.0	15.0	0.65	5.0
GSRC/U 0810 (含 0.6 φ 以上)	10.1	10.6	13.5	14.0	15.0	0.65	5.0
GSRC/U 0912 (不含 0.6 φ 以下)	10.5	11.0	16.0	16.5	15.0	0.80	5.0
GSRC/U 0912 (含 0.6 φ 以上)	11.1	11.6	16.0	16.5	15.0	0.80	5.0
GSRC/U 1012 (不含 0.6 φ 以下)	12.0	12.5	16.0	16.5	15.0	0.80	6.0
GSRC/U 1012 (含 0.6 φ 以上)	12.6	13.1	16.0	16.5	15.0	0.80	6.0
GSRC/U 1016	12.0	12.5	20.5	21.0	15.0	0.80	6.0

✱Design as Customer's Requested Specifications. (可依客戶特殊需求設計)

# Radial Choke Inductors

## GSRC0406

Electrical Characteristics for GSRC0406 Series [GSRC0406 系列電子特性規格]

Part Number 產品料號	Inductance ( $\mu$ H) 電感值 (L)	Test Freq. (KHz) 測試頻率	DCR ( $\Omega$ ) (max) 直流阻抗	IDC (A) (max) 定格電流
GSRC□0406 – 1R0N	1.00	1	0.030	3.00
GSRC□0406 – 1R5N	1.50	1	0.035	2.80
GSRC□0406 – 1R8N	1.80	1	0.040	2.70
GSRC□0406 – 2R2N	2.20	1	0.045	2.50
GSRC□0406 – 2R7N	2.70	1	0.050	2.50
GSRC□0406 – 3R3N	3.30	1	0.055	2.20
GSRC□0406 – 3R9N	3.90	1	0.055	2.20
GSRC□0406 – 4R7N	4.70	1	0.065	2.00
GSRC□0406 – 5R6N	5.60	1	0.070	1.80
GSRC□0406 – 6R8N	6.80	1	0.080	1.70
GSRC□0406 – 8R2N	8.20	1	0.090	1.50
GSRC□0406 – 100M	10.00	1	0.110	1.40
GSRC□0406 – 120M	12.00	1	0.140	1.20
GSRC□0406 – 150M	15.00	1	0.160	1.00
GSRC□0406 – 180M	18.00	1	0.180	1.00
GSRC□0406 – 220M	22.00	1	0.250	0.90
GSRC□0406 – 270M	27.00	1	0.370	0.80
GSRC□0406 – 330M	33.00	1	0.420	0.70
GSRC□0406 – 390M	39.00	1	0.450	0.70
GSRC□0406 – 470M	47.00	1	0.500	0.60
GSRC□0406 – 560M	56.00	1	0.560	0.60
GSRC□0406 – 680M	68.00	1	0.630	0.55
GSRC□0406 – 820M	82.00	1	0.770	0.50
GSRC□0406 – 101M	100.00	1	0.850	0.40
GSRC□0406 – 121M	120.00	1	1.300	0.40
GSRC□0406 – 151M	150.00	1	1.400	0.30
GSRC□0406 – 181M	180.00	1	2.200	0.30
GSRC□0406 – 221M	220.00	1	2.500	0.28
GSRC□0406 – 271M	270.00	1	2.700	0.25
GSRC□0406 – 331M	330.00	1	3.000	0.22
GSRC□0406 – 391M	390.00	1	3.400	0.21
GSRC□0406 – 471M	470.00	1	3.900	0.20
GSRC□0406 – 561M	560.00	1	5.000	0.16
GSRC□0406 – 681M	680.00	1	7.000	0.15
GSRC□0406 – 821M	820.00	1	7.700	0.14
GSRC□0406 – 102M	1000.00	1	8.700	0.12

※Test Freq. : 1KHz / 0.25V.

※Operating Temp. :  $-40^{\circ}\text{C} \sim +125^{\circ}\text{C}$

※Inductance drop = 10% typ. at IDC.

※Storage Temperature&Humidity :  $\leq 40^{\circ}\text{C}$  & 70% RH maximum

# Radial Choke Inductors

## GSRC0608

Electrical Characteristics for GSRC0608 Series [GSRC0608 系列電子特性規格]

Part Number 產品料號	Inductance ( $\mu$ H) 電感值 (L)	Test Freq. (KHz) 測試頻率	DCR ( $\Omega$ ) (max) 直流阻抗	IDC (A) (max) 定格電流
GSRC□0608 – 1R0N	1.00	1	0.015	3.00
GSRC□0608 – 1R2N	1.20	1	0.015	2.80
GSRC□0608 – 1R5N	1.50	1	0.015	2.70
GSRC□0608 – 2R2N	2.20	1	0.015	2.60
GSRC□0608 – 2R7N	2.70	1	0.020	2.50
GSRC□0608 – 3R3N	3.30	1	0.020	2.50
GSRC□0608 – 3R9N	3.90	1	0.025	2.50
GSRC□0608 – 4R7N	4.70	1	0.025	2.30
GSRC□0608 – 5R6N	5.60	1	0.030	2.10
GSRC□0608 – 6R8N	6.80	1	0.030	1.80
GSRC□0608 – 8R2N	8.20	1	0.035	1.20
GSRC□0608 – 100M	10.00	1	0.045	1.00
GSRC□0608 – 120M	12.00	1	0.050	1.00
GSRC□0608 – 150M	15.00	1	0.055	0.90
GSRC□0608 – 180M	18.00	1	0.090	0.90
GSRC□0608 – 220M	22.00	1	0.095	0.80
GSRC□0608 – 270M	27.00	1	0.110	0.75
GSRC□0608 – 330M	33.00	1	0.125	0.70
GSRC□0608 – 390M	39.00	1	0.140	0.65
GSRC□0608 – 470M	47.00	1	0.160	0.60
GSRC□0608 – 560M	56.00	1	0.180	0.60
GSRC□0608 – 680M	68.00	1	0.200	0.56
GSRC□0608 – 820M	82.00	1	0.270	0.48
GSRC□0608 – 101M	100.00	1	0.310	0.45
GSRC□0608 – 121M	120.00	1	0.370	0.43
GSRC□0608 – 151M	150.00	1	0.470	0.40
GSRC□0608 – 181M	180.00	1	0.540	0.40
GSRC□0608 – 221M	220.00	1	0.730	0.38
GSRC□0608 – 271M	270.00	1	0.830	0.32
GSRC□0608 – 331M	330.00	1	0.950	0.30
GSRC□0608 – 391M	390.00	1	1.220	0.25
GSRC□0608 – 471M	470.00	1	1.630	0.22
GSRC□0608 – 561M	560.00	1	1.800	0.20
GSRC□0608 – 681M	680.00	1	2.100	0.18
GSRC□0608 – 821M	820.00	1	2.900	0.17
GSRC□0608 – 102M	1000.00	1	3.200	0.15

※Test Freq. : 1KHz / 0.25V.

※Operating Temp. :  $-40^{\circ}\text{C} \sim +125^{\circ}\text{C}$

※Inductance drop = 10% typ. at IDC.

※Storage Temperature&Humidity :  $\leq 40^{\circ}\text{C}$  & 70% RH maximum

# Radial Choke Inductors

## GSRC0810

Electrical Characteristics for GSRC0810 Series [GSRC0810 系列電子特性規格]

Part Number 產品料號	Inductance ( $\mu$ H) 電感值 (L)	Test Freq. (KHz) 測試頻率	DCR ( $\Omega$ ) (max) 直流阻抗	IDC (A) (max) 定格電流
GSRC□0810 – 1R0N	1.00	1	0.015	4.50
GSRC□0810 – 1R5N	1.50	1	0.020	4.50
GSRC□0810 – 2R2N	2.20	1	0.020	4.20
GSRC□0810 – 2R7N	2.70	1	0.020	4.20
GSRC□0810 – 3R3N	3.30	1	0.020	4.00
GSRC□0810 – 3R9N	3.90	1	0.020	4.00
GSRC□0810 – 4R7N	4.70	1	0.025	4.00
GSRC□0810 – 5R6N	5.60	1	0.025	4.00
GSRC□0810 – 6R8N	6.80	1	0.025	4.00
GSRC□0810 – 8R2N	8.20	1	0.035	3.80
GSRC□0810 – 100M	10.00	1	0.040	3.80
GSRC□0810 – 120M	12.00	1	0.040	3.20
GSRC□0810 – 150M	15.00	1	0.045	2.80
GSRC□0810 – 180M	18.00	1	0.060	2.50
GSRC□0810 – 220M	22.00	1	0.070	2.10
GSRC□0810 – 270M	27.00	1	0.085	2.00
GSRC□0810 – 330M	33.00	1	0.090	1.80
GSRC□0810 – 390M	39.00	1	0.100	1.60
GSRC□0810 – 470M	47.00	1	0.110	1.50
GSRC□0810 – 560M	56.00	1	0.150	1.30
GSRC□0810 – 680M	68.00	1	0.190	1.00
GSRC□0810 – 820M	82.00	1	0.210	0.90
GSRC□0810 – 101M	100.00	1	0.240	0.80
GSRC□0810 – 121M	120.00	1	0.260	0.80
GSRC□0810 – 151M	150.00	1	0.310	0.75
GSRC□0810 – 181M	180.00	1	0.380	0.70
GSRC□0810 – 221M	220.00	1	0.430	0.65
GSRC□0810 – 271M	270.00	1	0.490	0.63
GSRC□0810 – 331M	330.00	1	0.660	0.60
GSRC□0810 – 391M	390.00	1	0.790	0.58
GSRC□0810 – 471M	470.00	1	0.910	0.52
GSRC□0810 – 561M	560.00	1	1.130	0.50
GSRC□0810 – 681M	680.00	1	1.300	0.40
GSRC□0810 – 821M	820.00	1	1.530	0.30
GSRC□0810 – 102M	1000.00	1	1.800	0.27

※Test Freq. : 1KHz / 0.25V.

※Operating Temp. :  $-40^{\circ}\text{C} \sim +125^{\circ}\text{C}$

※Inductance drop = 10% typ. at IDC.

※Storage Temperature&Humidity :  $\leq 40^{\circ}\text{C}$  & 70% RH maximum

# Radial Choke Inductors

## GSRC0912

Electrical Characteristics for GSRC0912 Series [GSRC0912 系列電子特性規格]

Part Number 產品料號	Inductance ( $\mu$ H) 電感值 (L)	Test Freq. (KHz) 測試頻率	DCR ( $\Omega$ ) (max) 直流阻抗	IDC (A) (max) 定格電流
GSRC□0912 – 1R0N	1.00	1	0.015	5.00
GSRC□0912 – 1R5N	1.50	1	0.015	5.00
GSRC□0912 – 1R8N	1.80	1	0.015	5.00
GSRC□0912 – 2R2N	2.20	1	0.015	5.00
GSRC□0912 – 3R3N	3.30	1	0.020	4.80
GSRC□0912 – 3R9N	3.90	1	0.020	4.80
GSRC□0912 – 4R7N	4.70	1	0.020	4.50
GSRC□0912 – 5R6N	5.60	1	0.025	4.00
GSRC□0912 – 6R8N	6.80	1	0.025	3.90
GSRC□0912 – 8R2N	8.20	1	0.025	3.50
GSRC□0912 – 100M	10.00	1	0.030	3.40
GSRC□0912 – 120M	12.00	1	0.030	3.20
GSRC□0912 – 150M	15.00	1	0.040	3.00
GSRC□0912 – 180M	18.00	1	0.045	2.80
GSRC□0912 – 220M	22.00	1	0.050	2.70
GSRC□0912 – 270M	27.00	1	0.055	2.50
GSRC□0912 – 330M	33.00	1	0.055	2.50
GSRC□0912 – 390M	39.00	1	0.060	2.00
GSRC□0912 – 470M	47.00	1	0.070	1.80
GSRC□0912 – 560M	56.00	1	0.080	1.70
GSRC□0912 – 680M	68.00	1	0.090	1.50
GSRC□0912 – 820M	82.00	1	0.110	1.40
GSRC□0912 – 101M	100.00	1	0.160	1.20
GSRC□0912 – 121M	120.00	1	0.170	1.10
GSRC□0912 – 151M	150.00	1	0.200	1.00
GSRC□0912 – 181M	180.00	1	0.220	0.90
GSRC□0912 – 221M	220.00	1	0.260	0.80
GSRC□0912 – 271M	270.00	1	0.390	0.70
GSRC□0912 – 331M	330.00	1	0.450	0.50
GSRC□0912 – 391M	390.00	1	0.490	0.45
GSRC□0912 – 471M	470.00	1	0.620	0.43
GSRC□0912 – 561M	560.00	1	0.640	0.40
GSRC□0912 – 681M	680.00	1	0.790	0.38
GSRC□0912 – 821M	820.00	1	1.340	0.35
GSRC□0912 – 102M	1000.00	1	1.820	0.30

※Test Freq. : 1KHz / 0.25V.

※Operating Temp. :  $-40^{\circ}\text{C} \sim +125^{\circ}\text{C}$

※Inductance drop = 10% typ. at IDC.

※Storage Temperature&Humidity :  $\leq 40^{\circ}\text{C}$  & 70% RH maximum

# Radial Choke Inductors

## GSRC1012

Electrical Characteristics for GSRC1012 Series [GSRC1012 系列電子特性規格]

Part Number 產品料號	Inductance ( $\mu$ H) 電感值 (L)	Test Freq. (KHz) 測試頻率	DCR ( $\Omega$ ) (max) 直流阻抗	IDC (A) (max) 定格電流
GSRC□1012 – 1R0N	1.00	1	0.010	6.00
GSRC□1012 – 1R5N	1.50	1	0.010	6.00
GSRC□1012 – 1R8N	1.80	1	0.015	6.00
GSRC□1012 – 2R7N	2.70	1	0.015	5.50
GSRC□1012 – 3R3N	3.30	1	0.015	5.50
GSRC□1012 – 3R9N	3.90	1	0.020	5.00
GSRC□1012 – 4R7N	4.70	1	0.020	5.00
GSRC□1012 – 5R6N	5.60	1	0.025	4.80
GSRC□1012 – 6R8N	6.80	1	0.025	4.80
GSRC□1012 – 8R2N	8.20	1	0.025	4.50
GSRC□1012 – 100M	10.00	1	0.025	4.50
GSRC□1012 – 120M	12.00	1	0.025	4.30
GSRC□1012 – 150M	15.00	1	0.035	4.30
GSRC□1012 – 180M	18.00	1	0.040	4.00
GSRC□1012 – 220M	22.00	1	0.045	3.70
GSRC□1012 – 270M	27.00	1	0.045	3.50
GSRC□1012 – 330M	33.00	1	0.055	3.00
GSRC□1012 – 390M	39.00	1	0.060	2.50
GSRC□1012 – 470M	47.00	1	0.080	2.30
GSRC□1012 – 560M	56.00	1	0.085	2.00
GSRC□1012 – 680M	68.00	1	0.095	2.00
GSRC□1012 – 820M	82.00	1	0.110	1.80
GSRC□1012 – 101M	100.00	1	0.140	1.70
GSRC□1012 – 121M	120.00	1	0.160	1.50
GSRC□1012 – 151M	150.00	1	0.180	1.40
GSRC□1012 – 181M	180.00	1	0.250	1.30
GSRC□1012 – 221M	220.00	1	0.280	1.00
GSRC□1012 – 271M	270.00	1	0.420	0.90
GSRC□1012 – 331M	330.00	1	0.540	0.80
GSRC□1012 – 391M	390.00	1	0.600	0.80
GSRC□1012 – 471M	470.00	1	0.660	0.70
GSRC□1012 – 561M	560.00	1	0.740	0.60
GSRC□1012 – 681M	680.00	1	0.840	0.50
GSRC□1012 – 821M	820.00	1	1.080	0.50
GSRC□1012 – 102M	1000.00	1	1.390	0.50

※Test Freq. : 1KHz / 0.25V.

※Operating Temp. :  $-40^{\circ}\text{C} \sim +125^{\circ}\text{C}$

※Inductance drop = 10% typ. at IDC.

※Storage Temperature&Humidity :  $\leq 40^{\circ}\text{C}$  & 70% RH maximum

# Radial Choke Inductors

## GSRC1016

Electrical Characteristics for GSRC1016 Series [GSRC1016 系列電子特性規格]

Part Number 產品料號	Inductance ( $\mu$ H) 電感值 (L)	Test Freq. (KHz) 測試頻率	DCR ( $\Omega$ ) (max) 直流阻抗	IDC (A) (max) 定格電流
GSRC□1016 – 1R0N	1.00	1	0.010	9.00
GSRC□1016 – 1R5N	1.50	1	0.015	9.00
GSRC□1016 – 1R8N	1.80	1	0.015	9.00
GSRC□1016 – 2R7N	2.70	1	0.015	9.00
GSRC□1016 – 3R3N	3.30	1	0.015	8.50
GSRC□1016 – 3R9N	3.90	1	0.015	8.00
GSRC□1016 – 4R7N	4.70	1	0.020	7.50
GSRC□1016 – 5R6N	5.60	1	0.025	7.50
GSRC□1016 – 6R8N	6.80	1	0.025	7.50
GSRC□1016 – 8R2N	8.20	1	0.025	7.20
GSRC□1016 – 100M	10.00	1	0.030	7.20
GSRC□1016 – 120M	12.00	1	0.030	7.00
GSRC□1016 – 150M	15.00	1	0.035	6.50
GSRC□1016 – 180M	18.00	1	0.035	6.30
GSRC□1016 – 220M	22.00	1	0.045	5.50
GSRC□1016 – 270M	27.00	1	0.050	4.50
GSRC□1016 – 330M	33.00	1	0.070	4.00
GSRC□1016 – 390M	39.00	1	0.070	3.80
GSRC□1016 – 470M	47.00	1	0.070	3.60
GSRC□1016 – 560M	56.00	1	0.080	3.20
GSRC□1016 – 680M	68.00	1	0.090	3.00
GSRC□1016 – 820M	82.00	1	0.095	2.60
GSRC□1016 – 101M	100.00	1	0.120	2.50
GSRC□1016 – 121M	120.00	1	0.140	2.30
GSRC□1016 – 151M	150.00	1	0.170	2.10
GSRC□1016 – 181M	180.00	1	0.190	2.00
GSRC□1016 – 221M	220.00	1	0.250	1.80
GSRC□1016 – 271M	270.00	1	0.340	1.50
GSRC□1016 – 331M	330.00	1	0.450	1.50
GSRC□1016 – 391M	390.00	1	0.510	1.30
GSRC□1016 – 471M	470.00	1	0.560	1.20
GSRC□1016 – 561M	560.00	1	0.640	1.00
GSRC□1016 – 681M	680.00	1	0.710	1.00
GSRC□1016 – 821M	820.00	1	1.010	0.90
GSRC□1016 – 102M	1000.00	1	1.200	0.80

※Test Freq. : 1KHz / 0.25V.

※Operating Temp. :  $-40^{\circ}\text{C} \sim +125^{\circ}\text{C}$

※Inductance drop = 10% typ. at IDC.

※Storage Temperature&Humidity :  $\leq 40^{\circ}\text{C}$  & 70% RH maximum