

EMI Line Filters

ECB8095

Features (特長)

- Closed magnetic circuit for lowest EMI (閉合磁性電路防 EMI 干擾對策)
- Highly accurate dimensions toroidal coil (高精度尺寸環型線圈)

Applications (用途)

- Copying Machine, Display Monitor, ADSL Modem, Gaming Machine, Color TV, Video Camera, Air Conditioner, Refrigerator, Laundry Machine, Microwave Oven and Car Electronics, etc.. (影印機、顯示監視器、寬頻數據機、遊戲機、彩色電視、攝影機、冷氣機、電冰箱、洗衣機、微波爐、汽車電子產品等)
- Microcomputer and peripheral devices (筆記型電腦和其周邊設備)



Product Identification (產品識別)

ECB8095 - ____ (Ex. ECB8095-5R6N / ECB8095-101Y)

1 2 3

1. Form (型式) (ECB8095)
2. Inductance or Turns (電感值 或 圈數)
4. Tolerance (誤差值) (參照表 N 30%, Y min)

Configurations & Dimensions (結構圖及規格尺寸)

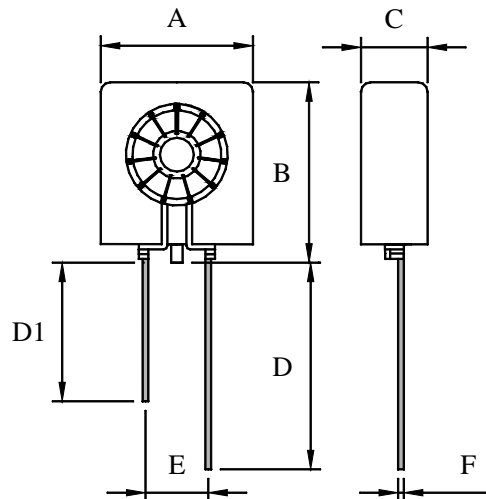

Unit In mm

Type (型式)	A (max)	B (max)	C (max)	D ±2.0	D1 ±2.0	E ±0.5	F ±0.1
ECB8095	8.0	9.5	3.5	19.5	15.0	5.0	0.6

♣ Design as Customer's Requested Specifications. (可依客戶特殊需求設計)